

VAIO DUO OVAL

- bathing with a friend: two identical back rests and centrally positioned outlet
- with integrated arm rests
- made of KALDEWEI steel enamel
- the moulded panel emphasises the high design standard and enables the bathtub to be free-standing
- IAPMO
- ASME A112.19.1
- CSA B45.2
- ASTM F-462
- Uniform Plumbing Code (UPC)
- National Plumbing Code (NPC)
- International Plumbing Code (IPC)

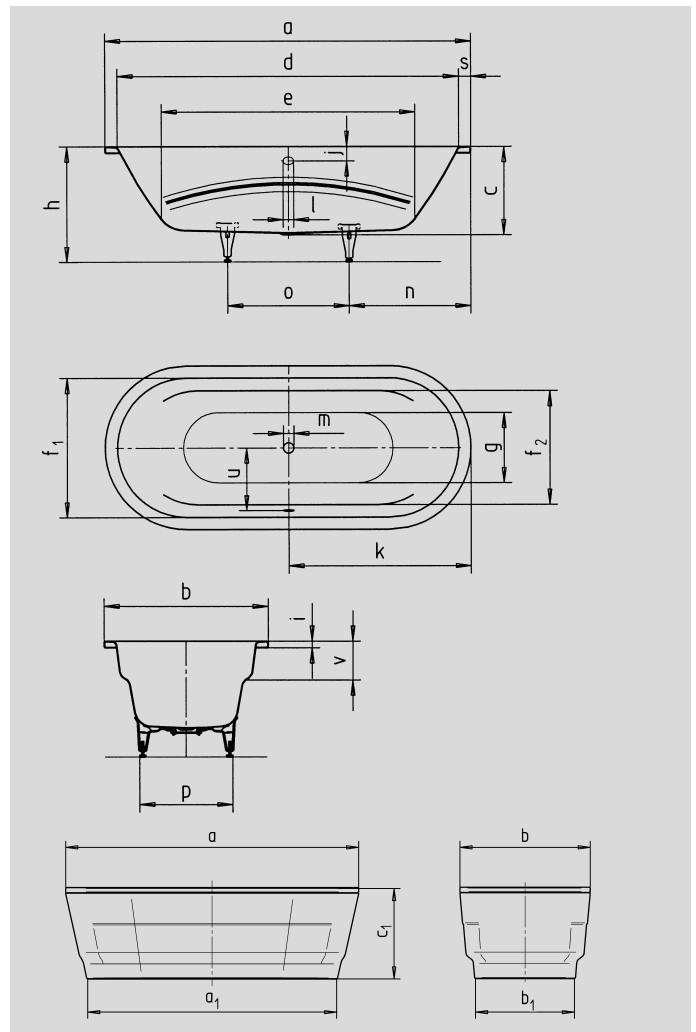

* Feet kit is an optional accessory

Model No.		inch
		951
External length	a	70.87
External width	b	31.50
Depth	c	16.93
External length (bottom)	a ₁	-
External width (bottom)	b ₁	-
Overall height with panel	c ₁	-
Internal length (top)	d	66.14
Internal length (bottom)	e	49.13
Internal width (top)	f ₁ ; f ₂	26.77; 21.85
Internal width (bottom)	g	13.50
Height with feet	h	21.65-23.23
Height of rim	i	1.26
Distance top edge to centre of overflow hole	j	2.76
Distance tub edge to centre of drain hole	k	35.43
Diameter of overflow hole	l	2.05
Diameter of drain hole	m	2.05
Distance foot end of tub edge to centre of foot	n	23.62
Distance between the feet	o	23.62
Max. width of feet	p	17.91
Width of rim (foot end; lengthwise)	s	2.36
Distance between centre holes	u	13.07
Armrest depth	v	7.09
Water volume** in gallons		40.94
Weight of the enamelled bath tub in lbs		112.44

Subject to technical alterations and tolerances.
 ** 18.49 gallons displacement on average.

KALDEWEI